

HRH1652M

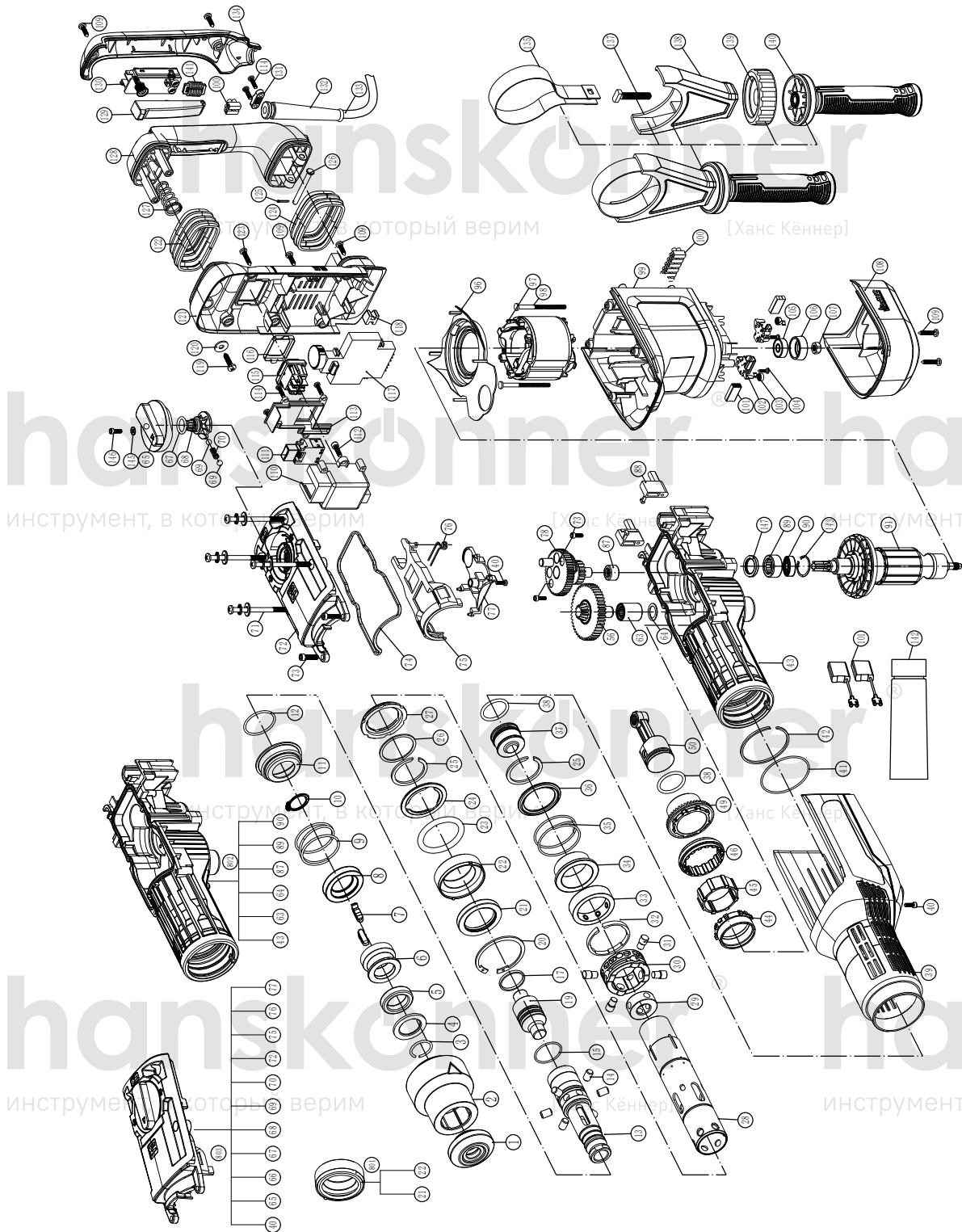

No.	Description	No.	Description
1	Hammer rod protector	77	Lifting jack
2	Flex Sheath	78	Eccentric gear subassembl
3	Φ28 Steel Wire Block Ring	87	Needle Bearing Φ12×Φ19×12
4	Support Washer	88	Screw bracket
5	Rubber Ring	89	Needle Bearing Φ20×Φ28×13
6	Lock Bead Sheath A	90	Seal ring subassembly
7	Insert block	91	Armature 220-240V
8	Spring Rack	96	Fan Guide
9	Flex Sheath Spring	97	Stator 220-240V
10	Φ30×2 Retaining Ring	98	Tapping Screw ST4.8×70×35
11	Cylinder Locking discs	99	Housing
12	Rubber Washer37×43×2.5	100	Rivet
13	Hammer Staff Sheath	101	Carbon Brush 220-240V
14	Cylinder Lock Bead Φ9×14	102	Carbon brush wire
15	Fluorin O-RingΦ33.2×Φ2	103	Coil spring
17	X-RingΦ25×Φ33×3	104	ST3.5×12Cross recessed pan head tapping screws
19	Impact Hammer	105	Ball Bearing 628LHV
20	Φ62 Retaining Ring	106	Bearing Ring
21	Oil Seal Ring Φ42×Φ58×8	107	Nut M8x1×3.8
22	Oiliness Bearing A	108	Fan Cover
23	O-RingΦ48.5×Φ7	109	Wide tooth ST4.8×20 Torx head self-tapping screw
24	Isolation pads	110	Switch Box
25	Φ42 Stop ring	111	Switch 1
26	Antifriction ring	112	Hex .Socket Bolt M5×12 (12.9)
27	Locating sleeve	113	Switch Box Cover
28	Cylinder	114	Tapping Screw ST4.2×16
29	Inner sliding block	115	Switch 2
30	Fixed Distance Sleeve	116	Switch 2 cover
31	Block lock bead	117	Speed Adjuster 220-240V
32	Clamp	118	Indicator
33	Shock absorption ring	119	Machine Screw ST5.5×25
34	sliding sleeve	120	Φ6 Flat Washer(Φ6.4×Φ18×1.6)
35	sliding sleeve Spring	121	Side Handle Ass'y Base
36	Limit ring	122	Top Shock Absorption Jacket
37	Impact piston	123	Wide tooth ST4.8×40 Torx head self-tapping screw
38	Fluorin O-RingΦ30.5×Φ3.5	124	Bottom Shock Absorption Jacket
39	Cover	125	Split Pin Φ2×14
40	Hex .Socket Bolt M4×12(12.9)	126	Shaft PinΦ6×55
41	O-RingΦ62×Φ2	127	Shock Absorption Spring
42	Φ62 Stop ring	128	Main Handle
43	Crank Housing	129	Switch Trigger
44	Oiliness Bearing B	130	Switch 3 220-240V
45	drive sleeve	131	Cord Clip
46	Clutch	132	Cord Armor
49	Big Cone-shaped Gear	133	Cord
50	Piston&Connecting subassembly	134	Main Handle Cover
56	Small Cone-shaped Gear Subassembly	135	Side Handle Ass' y Steel Tie
63	Needle Bearing14×22×26.5	137	"T"Bolt
64	Limit shimsΦ15×Φ22×1	138	Side Handle Ass' y Base
65	Function Knob	139	Side Handle cover
67	O-RingΦ16×Φ3	140	Side Handle
68	Dial Staff Sheath	141	Electricity Feels
69	SΦ7 Steel Ball	142	Oil Bottle
70	Dial Staff Sheath Spring	143	Φ31 Retaining Ring
71	Three combinations of wide tooth ST5.5 ×85 Torx head self-tapping screw	145	Φ4 Flat Washer
72	Gear Cover	146	ST4.2×14 Tapping Screw
73	Hex .Socket Bolt Non-Standard screw M5×20(12.9)	147	Oil Seal Ring φ13xφ19x3
74	Airproof Ring	801	Oiliness Bearing A Subassembly
75	selector fork	802	Crank Housing Subassembly
76	torsion spring	803	Gear Cover Subassembly